

ROUTINE CARE OF YOUR BRANOM CABINETS

For day to day maintenance, regular dusting with a dry cloth is recommended.

When wiping your cabinetry, either dusting or cleaning, wiping with the grain of the wood is recommended.



Cleaning requires only wiping with a damp cloth and then drying. To remove general soil, the coated surface may be cleaned with a fresh solution of mild soap and water. The cloth should be soft and dampened with the soap solution. The surface should then be wiped down with a dry cloth to remove excess moisture. In all cases it is important to ensure that any “puddled” water be soaked up and the surface then dried.

Other cleaning compounds exist but may contain alkaline reagents or other ingredients which may damage the coated surface. Over time these materials can soften the finish potentially leading to film failure. The softening may also lead to incidental damage from environmental influences such as water or moisture damage, increased susceptibility to scratching or abrasion, and staining.

Household polishes can be used on an infrequent basis, however these products generally contain wax which will cause wax build-up and leave a residue that is difficult to remove.

Points to remember

Routine cleaning will help to prevent long term damage from smoke, dirt and grease which will form a film over time, dulling and discoloring the finish. Where possible, keep finish away from exposure to direct sun. Over time sunlight may mellow or change the color of the finish, or it may lighten or darken the color. Avoid extremes in temperature or moisture as they can cause wood to expand or contract leading to potential coating damage.

Drawer System Adjustment/Removal



Remove the drawerbox by simultaneously squeezing both the left side and right side clip levers (indicated).

Adjust the drawer head by simply sliding the left or right clip adjustment tab (indicated) forward or backward to adjust the drawer head up or down. Repeat for each side to align the drawer head squarely within the drawerbox opening.

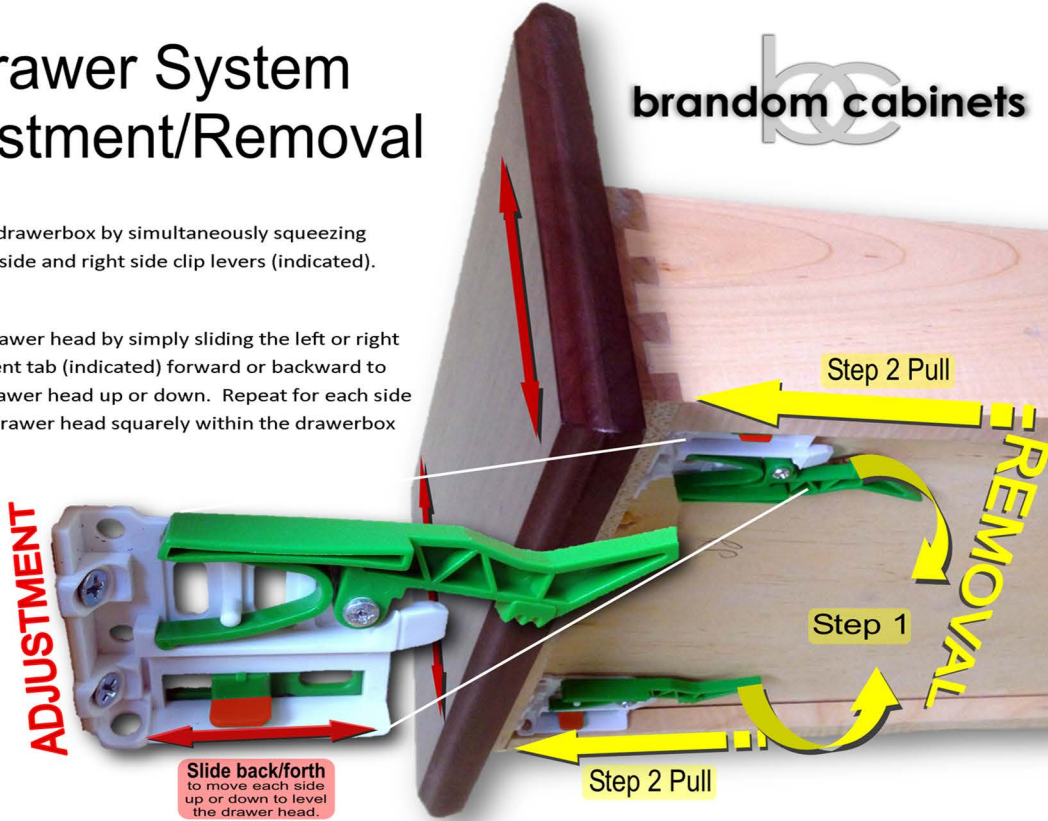

Slide back/forth to move each side up or down to level the drawer head.



Face Frame Hinges

- One piece hinge and base plate combination
- 3 dimensional adjustment
- 10.7 mm (7/16") cup drilling depth
- Front locating tabs position hinge on face frame
- Cam side adjustment
- Cam depth adjustment
- Height adjustment at mounting screw
- Works with current Grass insertion machinery



Face Frame Hinges

- One piece hinge and base plate combination
- For door thickness of up to 3/4"
- Front locating tabs position hinge on face frame
- Cam side adjustment
- Cam depth adjustment
- Height adjustment at mounting screw
- Works with current Grass insertion machinery

Hinge Adjustment

Standard Overlay/
Full Overlay

- 1 Left/Right
- 2 In/Out
- 3 Up/Down